



DISCUSSION GUIDE

May 2026

Strengthening the Visitor Experience at Tommy Thompson Park and the Leslie Street Spit

Tommy Thompson Park is one of Toronto’s most distinctive and ecologically significant landscapes – it is a very special place.

Based on direction from Toronto City Council, the City of Toronto and Toronto and Region Conservation Authority (TRCA) are jointly moving ahead with the creation of a Visitor Experience Plan to **ensure that Tommy Thompson Park’s user experience befits its unique and signature status as a regional destination where visitors can experience an urban wilderness on Toronto’s waterfront.**

Tommy Thompson Park is one part of the Leslie Street Spit, which is owned and managed by different entities, including the City of Toronto, TRCA, the Ontario Ministry of Natural Resources (which leases their land to the Toronto Port Authority), and CreateTO.

The Study Area for the Visitor Experience Plan (VEP) will focus on the Spit as a whole. Short-term implementation will be focused on TRCA-owned and City-owned lands. Recommendations for provincially-owned lands will require discussion and cooperation with the Ontario Ministry of Natural Resources and Toronto Port Authority.



Community Feedback will Help Shape this Plan

There will be two important touch-points with the community, including:

- **SPRING 2026** to understand how you use the Spit today, including what’s working well, not as well, and ideas for improvements.
- **FALL 2026** to share and seek feedback on core elements of the draft Visitor Experience Plan

The VEP is expected to be complete in early 2027.

For more info, checkout the website:

tommythompsonpark.ca/visitor-experience-plan/

We Are Here!

Checkout pg. 4 for upcoming engagement activities.



What the VEP Will and Will Not Contemplate

The 1992 Tommy Thompson Park Master Plan and Environmental Assessment is a foundation document guiding what happens in Tommy Thompson Park and the broader Leslie Street Spit.

The Master Plan has four core objectives:



Preserve significant species



Protect environmentally significant areas



Enhance aquatic and terrestrial habitat



Enhance recreational opportunities

The VEP will identify projects and priorities that will improve visitor experience at the park.

The VEP will not suggest major changes to the physical or operational priorities of the park. The VEP will not contemplate new buildings or servicing infrastructure outside of existing clearings, or south of the Nature Centre.

It will ensure free access is maintained, it will maintain the ban on pets.

What is a Visitor Experience Plan?

A Visitor Experience Plan (VEP) is a framework that guides how people will enjoy, navigate, and connect with a park while protecting its natural and cultural features.

The VEP will identify priorities and projects that balance recreation, conservation, and visitor needs to create meaningful, welcoming experiences for all.

Areas of focus for the VEP include:

- Natural environment
- Entering & moving through the park
- Accessibility
- Safety & wellbeing
- Operations & maintenance
- Branding & communications
- Facilities & amenities
- Equity & inclusion
- Programming, events, recreational opportunities

What might be considered for the VEP?

Things like:

- Interpretive and educational signage
- Wayfinding and trail mapping
- Nature viewing points/lookouts
- Seating, waste receptacles, shade, bikeshare, bike parking
- Website, newsletters, or social media
- On site staff/programming
- Site security/bylaw enforcement/emergency response
- Accessibility features
- Access to water

Land Ownership on the Leslie Street Spit

The chart and map below identify land ownership on the Leslie Street Spit, including Tommy Thompson Park. The process of developing the Visitor Experience Plan involves all landowners.

Land Component	Hectares	Acres	Ownership	Management
Tommy Thompson Park	247	610	TRCA	TRCA / City of Toronto
Outer Harbour East Headland and Endikement	216	534	Ontario Ministry of Natural Resources	Toronto Port Authority
Baselands	37	91	CreateTO / City	CreateTO / City
Ashbridges Bay Landform New Nature Areas	3.75	9	City of Toronto and TRCA	TRCA

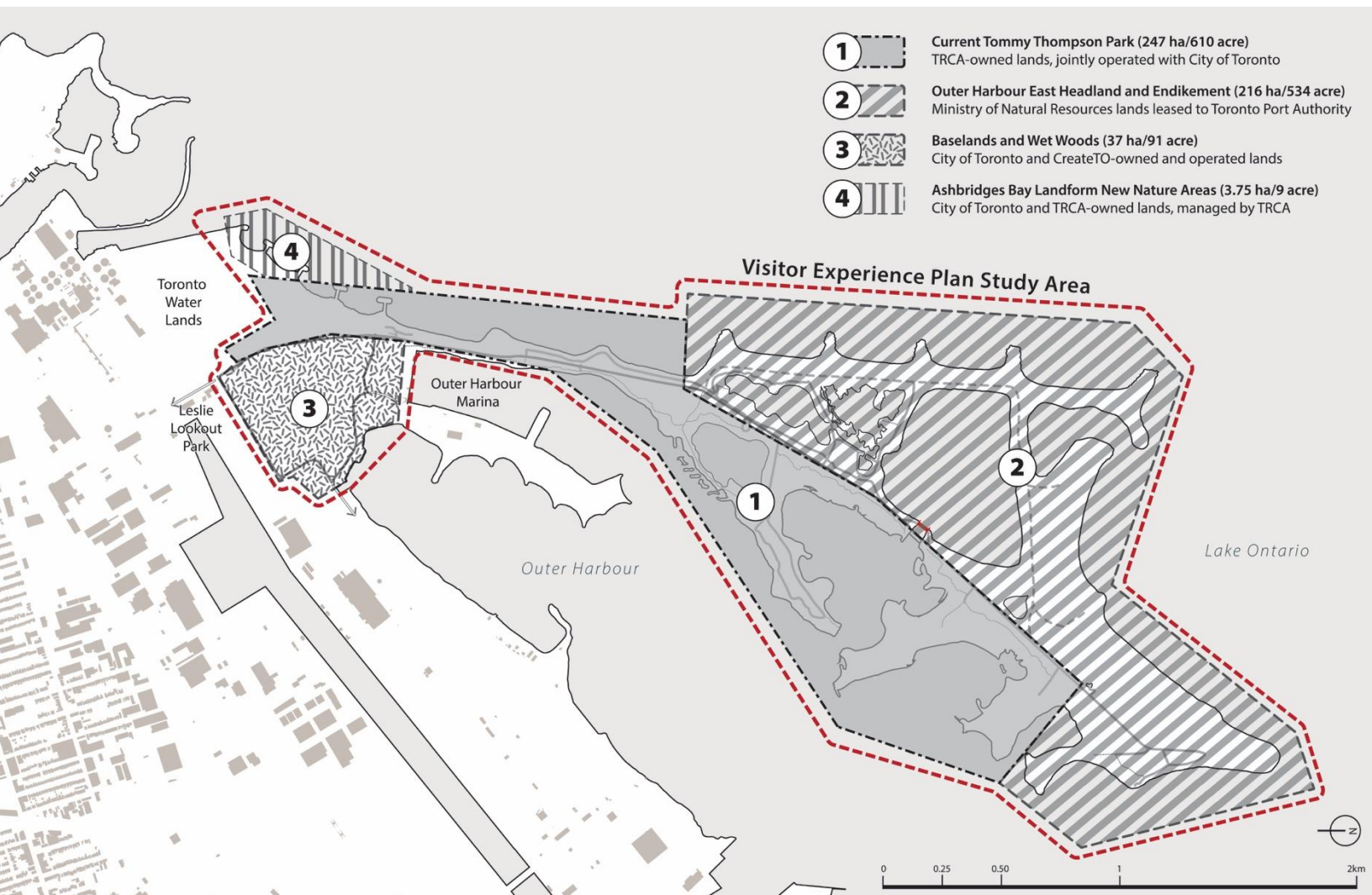

QUESTIONS FOR YOU

Think about your experience and the experience of other visitors to Tommy Thompson Park and the Leslie Street Spit and share your thoughts with us at one of the many engagement activities:

1. What's working well?
2. What's not working as well?
3. Do you have any ideas for improvement? Where in Tommy Thompson Park and/or the Leslie Street Spit would you like to see those ideas considered?
4. Do you have any other feedback for the team at this time?

ENGAGEMENT ACTIVITIES:

There are lots of ways to get involved and share your thoughts!



Talk to us at the Pop-up (part of the Spring Bird Festival!)

Saturday, May 9, 2026, 11 am – 2 pm

Look for us under the *blue tent* beside the parking lot



Come to the Public Meeting

Tuesday, May 12, 2026

6:30 to 8:30 p.m.

Ralph Thornton Community Centre (fully accessible)
765 Queen Street East



Complete the Online Survey

Opens: Tuesday, April 21, 2026

Closes: Tuesday, May 19, 2026

To learn more, checkout the project website at:

tommythompsonpark.ca/visitor-experience-plan/



Scan here to take survey*

*If you would prefer to respond to the survey by telephone or paper copy, or to request accessibility accommodations for the public meeting, please contact Matthew Wheatley from the Third Party Public team supporting the engagement process on behalf of the City of Toronto and the TRCA at 416-572-4365 or matthew@thirdpartypublic.ca.

CONTACTS

City of Toronto, Danny Brown, DBrownJ@toronto.ca

TRCA, Mary Anne Young, Maryanne.Young@trca.ca (416) 661-6600

Third Party Public (VEP engagement team), Matthew Wheatley, matthew@thirdpartypublic.ca (416) 572-4365